

**FLYTECH**

POS316 | POS317 | POS319

# POS 310 Series

Slim POS Solutions



# Choose Your Processor For Limitless Possibilities

Tailor your business operations with the flexibility to select from two powerful processor platforms – the **MediaTek G700** and **Intel® Elkhart Lake N6210**.

**MEDIATEK**

**Genio 700 MT8390**

CPU

**4GB LPDDR4 + 64GB eMMC**

Memory

**Android 13 (GMS\*)**

OS

**intel.**

**Intel® N6210**

CPU

**4GB DDR4 + 128GB eMMC**

Memory

 **Windows**  **Linux**  **Android 13**

OS

*\* GMS is planned to be launched by Q1 2024.*

# Select Your View with Varied Screen Sizes

POS310 series is designed with the freedom to choose from three screen sizes – **11.6"**, **15.6"** and **21.5"**. Tailor your POS solution to fit your unique business needs, ensuring seamless integration whether your space is compact or expansive.





# Dual Displays with Flexible Mounts

Elevate your customer interactions with a choice of a second display in 11.6". Designed with the flexibility of dual mounting options, you can seamlessly integrate it on the stand for a unified solution, or opt for individual stand mounting for customized positioning.

Mount on the 2<sup>nd</sup> Display Stand (ST11)



Mount on the Main Stand (ST12)



## 3 Mounting Options for 2<sup>nd</sup> Display



Upper Viewing Angle



Middle Viewing Angle



Lower Viewing Angle

# Seamless Transactions and Rich Insights

Embrace the future of POS technology with our NFC-enabled 2<sup>nd</sup> display\* and 2MP/5MP camera – a perfect blend of functionality and customer-centric innovation.

*\* The NFC-enabled 2<sup>nd</sup> display is a project-specific option.*

The optional **2MP/5MP camera** takes customer engagement to the next level, capturing valuable consumer data for in-depth marketing analysis



Customers can conveniently use their mobile phones, simply get close to the 2nd display, and enable the **NFC** function for secure and contactless payments.

# Choose Your Module Made Easy

Changing configurations is a breeze – simply swap modular boxes as needed. This approach enhances adaptability, allowing customers to effortlessly change and adapt their setup to meet specific business needs.

## Display Monitor Module

Transform your display for a versatile touch monitor experience.

*\* plastic housing*

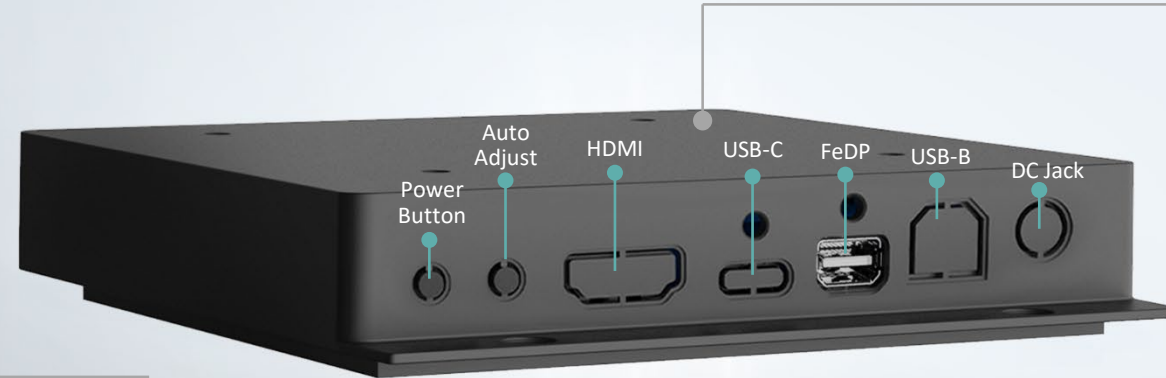

## Touch PC Module

Transform your display into an all-in-one Panel PC and POS terminal.

*\* die-casting housing*

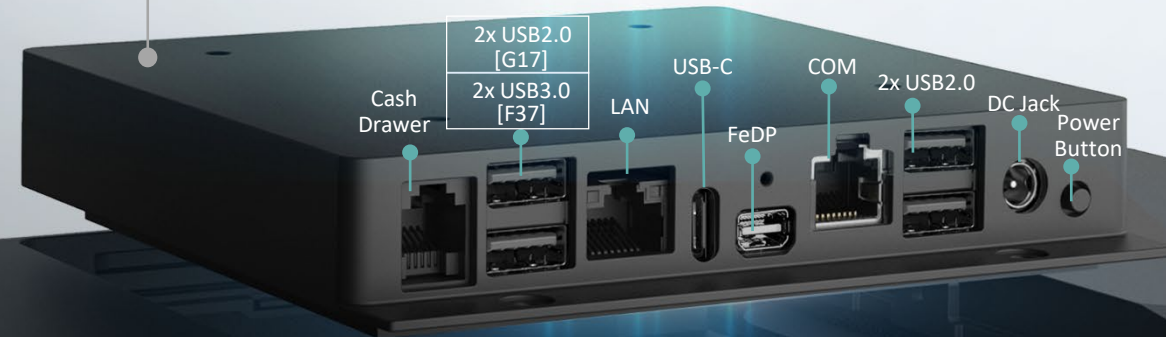



# Versatility of Display Monitor Module

Tailor your visual experience with our Display Monitor Module, offering a selection of three SKUs to match your unique display interface requirements.

Scaler Board (D04)							
	Power Button	Auto Adjust	HDMI	USB-C	FeDP	USB-B (DisplayLink)	DC Jack
SKU1	✗	✗	✗	✗	✓	✗	✗
SKU2*	✓	✓	✓	✓	✗	✗	✓
SKU3*	✓	✓	✗	✗	✗	✓	✓

*\*SKU2/SKU3 are project-specific options.*

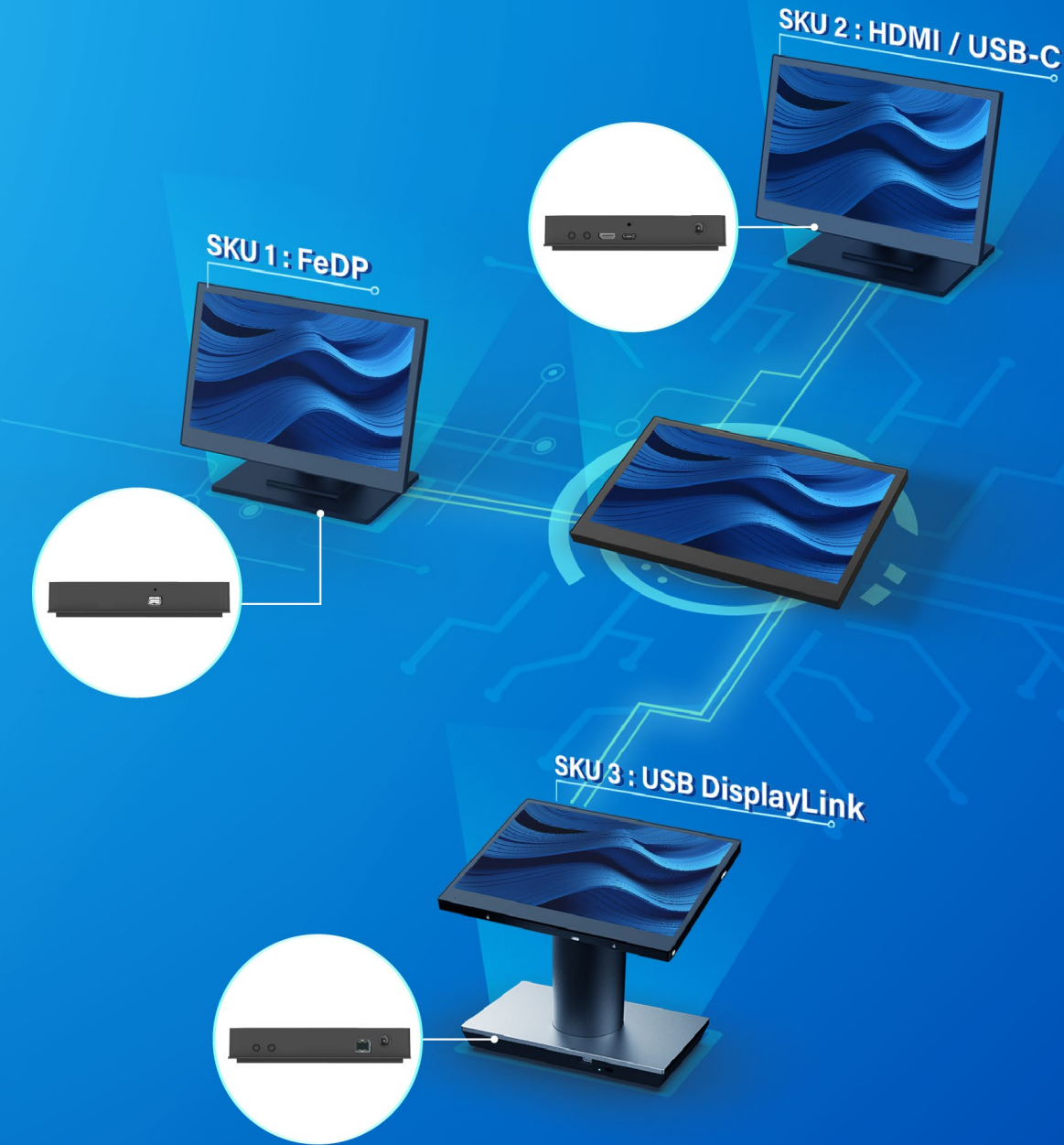

# Enhanced Functionality with Peripherals

POS310 series offers a wide range of peripherals that can be easily mounted on the right side of the display. Enjoy seamless integration and enhanced functionality, creating a personalized solution that empowers your business and elevates the customer experience.

*\* The peripheral can be mounted only on the right side of the display system.*

*\* The peripherals of the fingerprint, scanner, RFID, and light bar are project-specific options.*

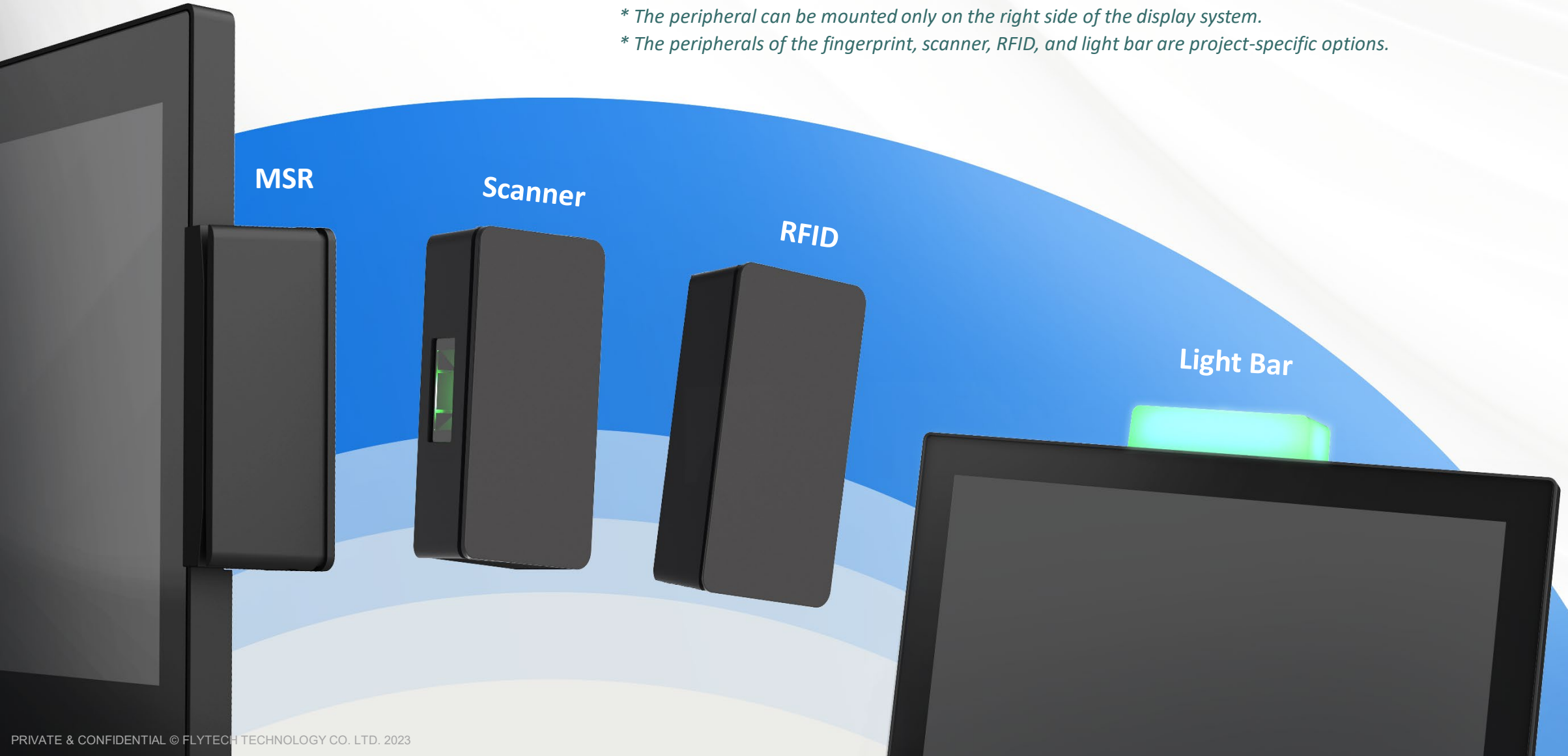



# Flexible Mounting Solutions

POS310 series boasts a modular design that goes beyond being a typical POS system. It effortlessly transitions into wall-mount, pole-mounted, and self-service kiosk solutions, maximizing convenience and adaptability for your operations.

Kiosk Printer Stand



Wall-Mounted



POS Stand



11.6" 2nd Display Stand



Pole-Mounted



Specifications: POS System (Touch PC Module)

	Model	POS316 / POS317 / POS319	
System	Motherboard	G17	F37
	Processor	MTK G700 (MT8390)	Intel® N6210
	Memory (on board)	4GB LPDDR4	4GB DDR4
	Storage (on board)	64GB eMMC	128GB eMMC
Display	Size & Resolution	POS316: 11.6" 1920 x 1080 POS317: 15.6" 1920 x 1080 POS319: 21.5" 1920 x 1080	
	Touch Screen	True-Flat PCAP multi-touch	
I/O Ports	USB Type-A	4x USB2.0	2x USB3.0, 2x USB2.0
	USB Type-C	1x USB3.0 full-functioned (DP/ PD 5V/2A, 12V/1A)	1x USB3.0 (Data only 5V/2A)
	FeDP	1x Flytech proprietary miniDP (for 2nd display)	
	Serial Port	1x RJ48 (Powered RS232) (default: 0V; control by factory: 5V, 12V)	
	LAN	1x RJ45	
	Cash Drawer	1x RJ11 (12V)	
	DC Jack	1x 2PIN	
	Power Button	1	
Audio	Internal Speaker	1x 3W (Option)	
Power	Power Supply	36W / 12V	
Communication	WLAN + BT	WiFi 6 + BT5.2 (default)	WiFi 6 + BT5.2 (Option)
Peripheral (option)	MSR	3-Track MSR (USB)	
	Fingerprint Reader*	Fingerprint Reader (USB)	
	2D Scanner*	2D Scanner (USB)	
	RFID Reader*	RFID Reader (USB)	
	Light Bar*	Light Bar Module (USB)	
Certificate	EMC & Safety	FCC Class A, CE Mark Class A, LVD	
Environment	Operating Temperature	0°C ~ 35°C (32°F ~ 95°F)	
	Storage Temperature	-20°C ~ 60°C (-4°F ~ 140°F)	
	Humidity	20% ~ 85% RH non-condensing	
Dimensions	W x H x D	POS316: 289 x 275 x 193 mm / POS317: 372 x 294 x 237 mm / POS319: 516 x 336 x 308 mm	
Mounting	VESA Mount	75 x 75 mm	
OS Supported		Android 13.0 (GMS)**	Windows 10 IoT Enterprise, Linux, Android 13.0

\* The peripherals of the fingerprint, scanner, RFID, and light bar are project-specific options.

\*\* GMS is planned to be launched by Q1 2024.

※ Product specifications and data are subject to change without notice

Specifications: Touch Monitor (Display Monitor Module)

	Scaler Board (D04)	SKU 1	SKU 2*	SKU 3*
		FeDP	HDMI / USB-C	USB DisplayLink
Display	Size & Resolution	D116: 11.6" 1366 x 768 D117: 15.6" 1920 x 1080 D119: 21.5" 1920 x 1080		
	Touch Screen	True-Flat PCAP multi-touch		
I/O Ports	Power Button	-	1	1
	Auto Adjust Button	-	1	1
	HDMI	-	1	-
	USB Type-B	-	-	1
	USB Type-C	-	1x USB2.0, supports Alt mode with PD (5V/3A, 12V/1.25A) from the system	-
	FeDP	1	-	-
	DC Jack	-	1x 2PIN	1x 2PIN
Power	Power Supply	36W / 12V		
Peripheral (option)	Camera	1x 2MP or 5MP Camera (*available only for 11.6" D116)		
Certificate	EMC & Safety	FCC Class A, CE Mark Class A, LVD		
Environment	Operating Temperature	0°C ~ 35°C (32°F ~ 95°F)		
	Storage Temperature	-20°C ~ 60°C (-4°F ~ 140°F)		
	Humidity	20% ~ 85% RH non-condensing		
Dimensions (Display)	W x H x D	D116: 289 x 193 x 29 mm D117: 372 x 238 x 30 mm D119: 516 x 308 x 40 mm		
Mounting	VESA Mount	75 x 75 mm 75 x 25 mm (*available only for 11.6" D116)		

\* SKU 2 & SKU 3 are project-specific options.

※ Product specifications and data are subject to change without notice



**FLYTECH**

POS316 | POS317 | POS319

# POS 310 Series

Slim POS Solutions

